

THE INFORMATION CONTAINED IN THIS DRAWING IS THE SOLE PROPERTY OF ANDERSON POWER PRODUCTS. ANY REPRODUCTION IN PART OR WHOLE WITHOUT THE WRITTEN PERMISSION OF ANDERSON POWER PRODUCTS IS PROHIBITED.

ANDERSON POWER PRODUCTS RESERVES THE RIGHT TO ALTER PRODUCT TYPES, THEIR TECHNICAL DATA, DIMENSION, STYLE AND ACCESSORIES WITHOUT PRIOR NOTIFICATION.

BY: DATE	**
DESCRIPTION OF CHANGES	**
REV. 1	DIM. MODIFICATION

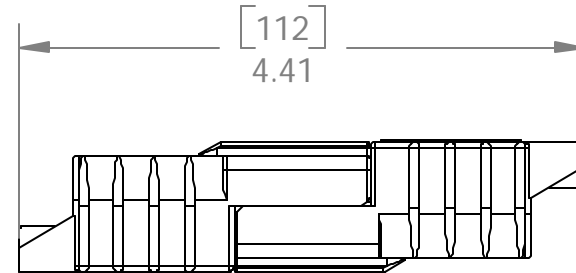
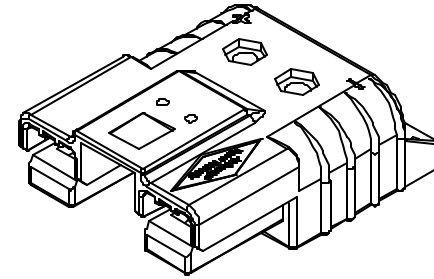
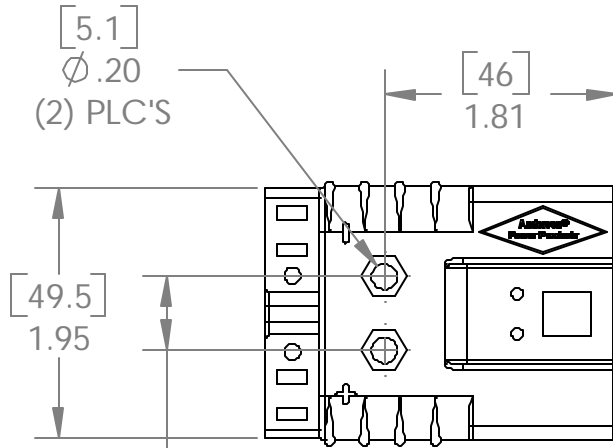

MATED PAIR

COMPLIES WITH EN1175-1 (FORMERLY EEC86/663 DIRECTIVE)

NOTES:

1. SPRING/HOUSING ASSEMBLIES ARE UL RECOGNIZED PER FILE E26226, CSA CERTIFIED PER LR25154, AND TUV CERTIFICATION NO. R0097579.05 TO DIN VDE 0117.
2. HOUSINGS ARE KEYPED TO ONLY ALLOW MATING WITH THE SAME COLOR HOUSING.
3. FOR ASSEMBLY INSTRUCTIONS SEE DOCUMENT 1S6331.
4. HOUSING ASSEMBLIES ACCOMODATE ANDERSON CONTACTS FOR WIRE SIZE 16MM (MAX. 80 AMPS) OR #6 AWG ONLY.
5. MATERIAL:
HOUSINGS - PBT, UL94V0
SPRINGS - STAINLESS STEEL
6. OPTIONAL AUXILIARY POWERPOLE HOUSINGS AND CONTACTS AVAILABLE.

COPYRIGHT 2004 ANDERSON POWER PRODUCTS. ALL RIGHTS RESERVED. UNAUTHORIZED REPRODUCTION HEREBY PROHIBITED.

DIMENSIONS ARE IN INCHES DIMENSIONS IN PARENTHESES () ARE IN MILLIMETERS		CAD GENERATED DRAWING, DO NOT MANUALLY UPDATE		ANDERSON POWER PRODUCTS		
TOLERANCES ARE: 2PL- ±.02 [±.5]		APPROVALS	DATE	SBO 60/SBE 80 HOUSING AND SPRING ASSEMBLY OUTLINE DRAWING		
MATERIALS: SEE NOTES		DRAWN	AMP			4/14/04
FINISH		CHECKED	DJD			4/15/04
NEXT ASSY		RESP ENG	MAW			4/15/04
USED ON		MFG ENG	DAM			4/15/04
APPLICATION		QUAL ENG	RPO	4/15/04	SIZE A	
DO NOT SCALE DRAWING		SCALE NONE		SPECIFICATION: 114129S1	REV. 1	
		CADFILES/00999		SHEET 1 OF 1		